

# **RUTLAND 504**

## **MARINE MOUNTING KIT**

Sunshine Solar Ltd  
Unit 29 Ashwellthorpe Ind Estate  
Ashwellthorpe  
Norwich, Norfolk  
NR16 1ER

tel: 01508 488188  
email: [sales@sunshinesolar.co.uk](mailto:sales@sunshinesolar.co.uk)

This mounting kit is designed for easy installation of the Rutland 504 Windcharger on most sailing yachts.

Please read through these instructions carefully before commencing installation.

1. Check you have received: ( Item numbers 1-8 refer to Fig. 1 )

1. 1 x Mounting Tube Upper Section.
2. 4 x Guy Brackets.
3. 6 x M8 x 12mm Screws and Lock Washer.
4. 1 x Aluminium Tube Joiner.
5. 1 x Mounting Tube Lower Section.
6. 2 x Deck Mounting Bracket.
7. 2 x M8 x 50 bolts, washers and lock nuts
8. 1 x M10 x 50 bolt and lock nut

2. What you will need:

1. Drill.
2. 8.5mm Drill Bit.
3. 13mm Spanner
4. 17mm Spanner
5. Suitable Deck Fixings.
6. Silicone Grease.
7. Suitable Guys and Fixings.
8. Suitable Cable and Watertight Cable Glands (if necessary).
9. Silicone Sealant.

3. Installation Considerations:

Choose a suitable location for the mounting, paying particular attention to fixing to the deck, suitable guy anchor points, and cable route.

The mounting kit can be installed using 3 or 4, wire rope or rigid guys.

Ensure the guy attachment points are as equally spaced as possible around the tube.

4. Fitting the Deck Mounting Brackets:

1. Choose a suitable location for fixing the deck mounting brackets.
2. Place the brackets on the deck and mark the hole positions.
3. Remove the brackets and drill the marked positions 8.5mm.
4. Apply silicone sealant around the holes and the area covered by the brackets.
5. Bolt the mounting brackets in position using suitable M8 fixings, ensuring a

5. Assemble the Mounting Tube:
  1. Apply silicone grease to the aluminium tube joiner and place half way in to the mounting tube lower section, ensuring the holes in the tube align with the threaded holes in the tube joiner. Secure in position using two of the M8 x 12mm screws and lock washers.
  2. Repeat the above procedure for the mounting tube upper section.
  3. Thread the cable through the assembled tube.
  4. Position the assembled mounting tube onto the deck mounting brackets and secure in position with the M10 x 50 bolt and lock nut.
  
6. Fitting the Guys:
  1. Secure the guy brackets in position using 2 M8 x 50mm bolts, lock washers and lock nuts.
  2. Make up guys of suitable lengths and attach to the guy brackets using shackles or other suitable fixings.
  3. Attach the other ends of the guys to suitable anchor points using rigging screws.
  4. Tension all guys ensuring that the mounting tube is vertical.
  5. Check all fixings are tight.

Fit wind generator in position on mounting tube in accordance with the Rutland 504 Owners Manual.

**N.B. Replace the 2 x M8 x 16 fixing screws supplied with the WG503 to 2 x M8 x 12 screws supplied with this mounting kit.**

## RUTLAND 504 MARINE MOUNTING KIT

The Rutland 504 Marine mounting kit offers easy installation of the Rutland 504 on any sailing boat. It is manufactured from stainless steel and is simple to assemble.

As each installation is individual the kit's design is as versatile as possible. The deck brackets can be mounted at an angle and the guy brackets can be used in varied combination for three or four guys. The guy brackets will accept wire or rigid guys according to your requirements.

(Not supplied).

Overall Height: 2.0 m.  
Net Weight: 3.0 kg.  
Packed Weight: 3.1 kg.  
Shipping Dims: 10 x 5 x 110cm.

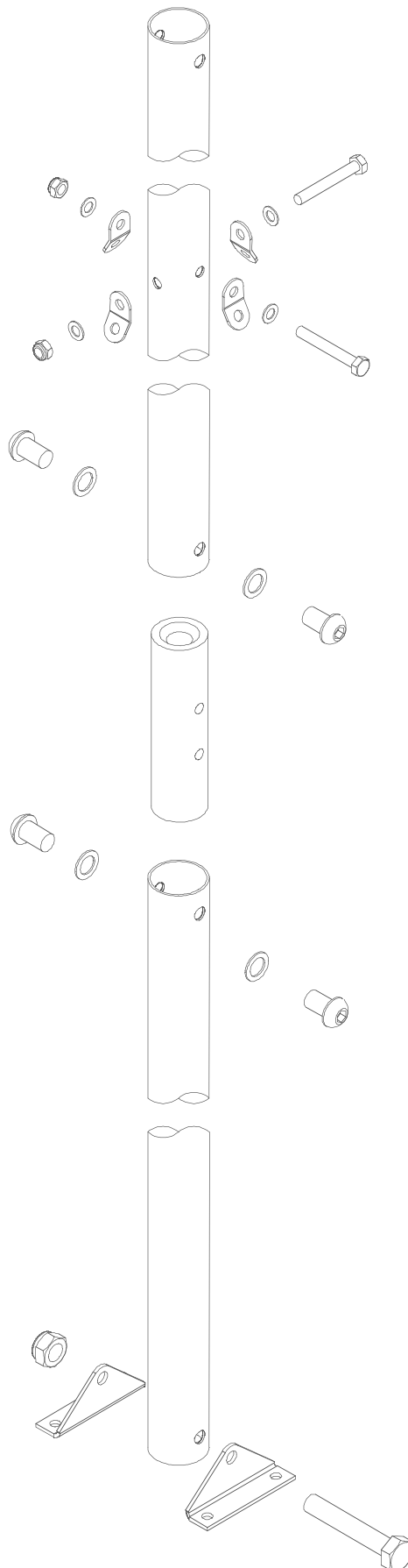

1. Mounting tube top section (1m) pre-drilled for Rutland 503 fixing.

2. 4 x brackets for guy attachment (Guys not included)

3. 2 x M8 x 50mm bolts, washers and lock nuts.

4. 4 x M8 x 12mm screws and washers.

5. Aluminium Tube Joiner.

6. Mounting tube lower section (1 m).

7. Deck mounting bracket.

8. 1 x M10 x 50mm bolt and lock nut.